



**VB-200 SERIES
QUICKSTART GUIDE**

INTRODUCTION

Welcome, and thank you for choosing Edesix as your Body Worn Camera provider. This simple guide will lead you through the set-up process of your VideoBadge VB-200.

Prior to using your VB-200, please ensure you have access to the VideoManager software. VideoManager can be purchased as a Licence to accompany this camera, or as a Cloud Service for your estate of VideoBage's.

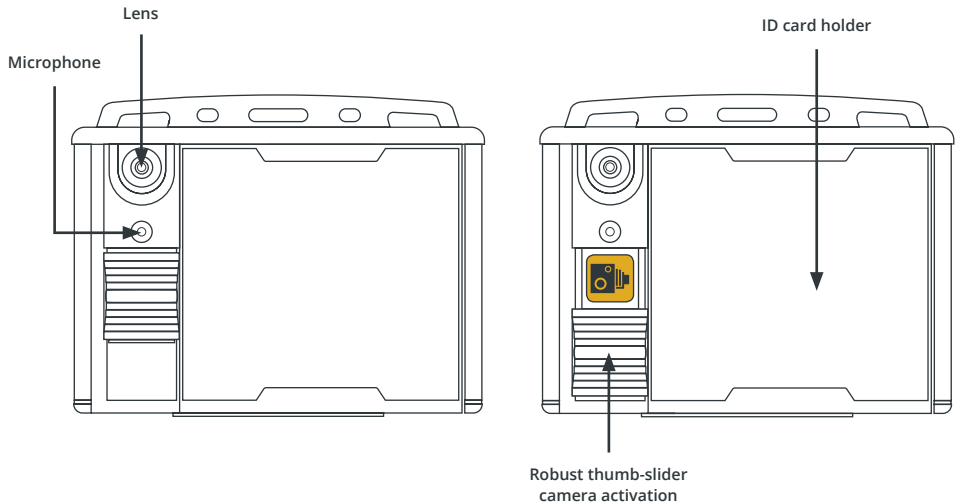

CHARGING YOUR DEVICE

Upon receiving your VideoBadge, it is recommended that you fully charge the device before usage. To enable charging you will require one of the following:

Solo Docking Station

- ✓ Connected to your laptop or PC

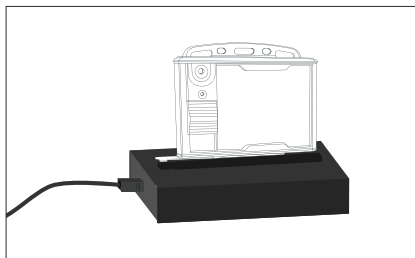

7 Slot Docking Station

- ✓ Connected to a power supply

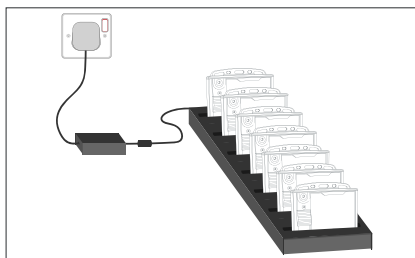

When charging using a Solo or 7 Slot docking station, the protective rubber port cover should be rotated as shown, and the badge securely inserted into the docking station.

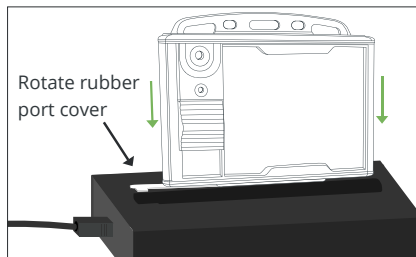
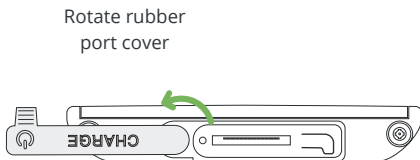

Laptop or PC

- ✓ Connected directly to your Laptop or PC

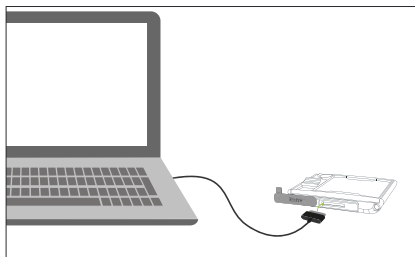

Once situated in the charging position, your VideoBadge will beep to indicate charging has commenced, and the LED, as indicated, will flash green to show charging. Please note that, if this same top right LED is flashing when the VideoBadge is removed from its dock, this indicates that the VideoBadge is in power-saving mode.

Once fully charged, the same LED will turn solid green. If the LED is not lit, the device is not charging.

Your VideoBadge will fully charge within 3 hours via a docking station, or 6 hours via USB directly connected to your laptop or PC.

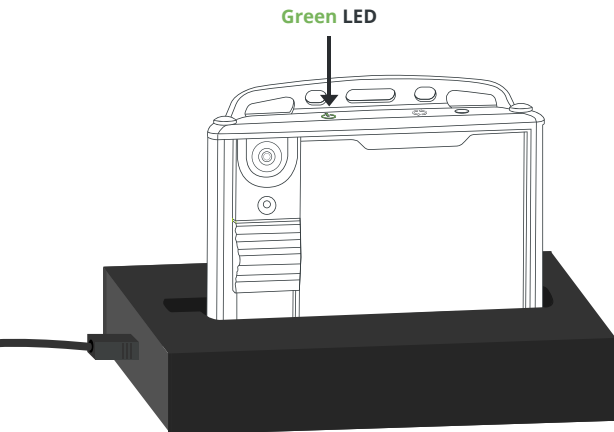

Please note: The charging times stated above will be shorter if your VideoBadge battery is not fully drained.

If your battery still has capacity, charging it further will not degrade the battery life.

CONFIGURING YOUR DEVICE

Prior to using your VideoBadge, your device must be configured and assigned to you.

There are two ways to assign and configure a VideoBadge:

- ✓ Using VideoManager
- ✓ Using an RFID Tag

An unassigned docked device will have a slowly pulsing green power LED, and a blinking Management LED. Once removed from the docking station the Power LED will become solid.

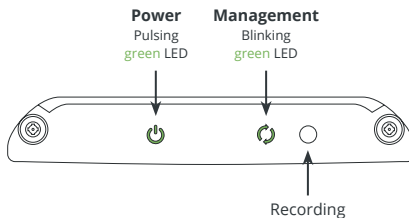

VB-200 Configuration Using VideoManager

The Power LED will stay pulsing green.
The Management LED will go out completely.

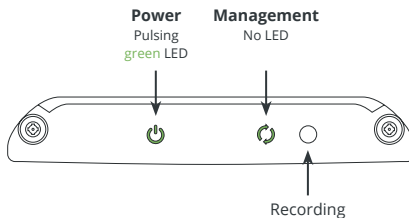

VB-200 Configuration Using an RFID Tag

- ✓ The power LED will flash red.
- ✓ The management LED will flash green.
- ✓ The recording LED will flash green.
- ✓ The device will beep at one-second intervals.

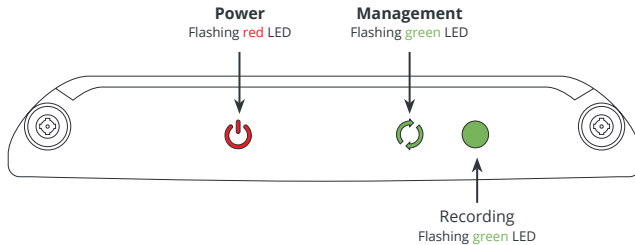

If, ten seconds after your VB-200 has been assigned using an RFID tag, it has still not been removed from its dock, the device's lights will return to normal (as indicated above) and it will stop beeping.

If you remove your VB-200 without assigning it to yourself, the management LED will stay a solid green and the device will beep continually, four times in quick succession, to alert you.

USING YOUR VIDEOBADGE

The Edesix VideoBadge VB-200 is intuitive and simple to use.

VideoBadge VB-200

To start/stop recording

To begin recording, simply slide the robust thumb slider button, located on the right-hand side of your badge, downwards. You will be alerted that your device is recording by a green LED on the top left of your device. If this LED is blinking, your device is pre-recording.

A single low bleep will also indicate recording is in process.

To end the recording process, the thumb slider should be slid upwards to its original position.

This will be accompanied by a single, high bleep and the top left LED will turn blank.

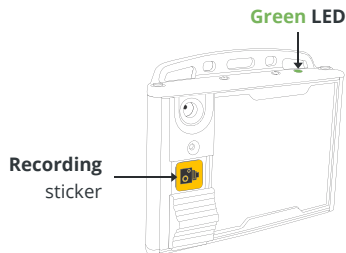
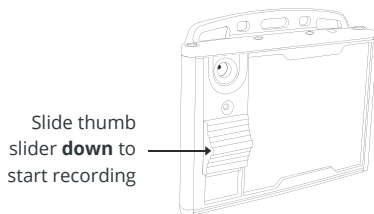

VideoBadge Status LEDs

VideoBadge has three status LEDs. It is important to check the status of your VideoBadge before use.

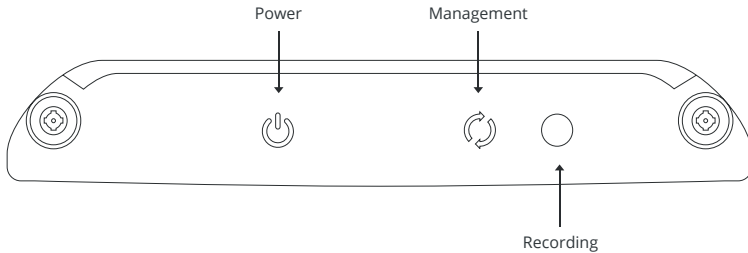

Power		
Green	If the VideoBadge is plugged in:	The device is fully charged
	If the VideoBadge is not plugged in:	The device is powered up
Throbbing	The device is plugged in and charging	
Blinking	The device is unplugged and is in power saving mode	
Off	The VideoBadge is switched off	
Orange / Red	If the VideoBadge is running low on batteries. Plug it in as soon as possible	

Management LED		
Green	The VideoBadge needs to be configured before you can use it. Plug it into the Manager computer	
Blinking	If the VideoBadge is plugged in:	The VideoBadge needs to be configured or assigned to an operator before it can be used
	If the VideoBadge is not plugged in:	The VideoBadge needs to be assigned to an operator and will beep repeatedly to alert you
Fast-Blinking	The VideoBadge has been assigned by touch assign	
Off	The VideoBadge is properly configured and can be used	

Recording LED		
Green	If the VideoBadge is plugged in:	The VideoBadge is recording
Blinking	The VideoBadge is pre-recording	

Please note: The camera should always remain upright when capturing footage.

Lastly, your VideoBadge comes equipped with a lanyard for easy wear. The lanyard should be attached to the clear mounting at the top of your VideoBadge.

Your VideoBadge can also be paired with a multitude of mountings and fixings. For further information on purchasing or using these accessories, please refer to the VideoBadge User Guide or contact our team directly.

You should now be ready to use your VideoBadge! We hope that you enjoy using your new Body Worn Camera. For further information, please refer to the VideoBadge and VideoManager User Manuals.

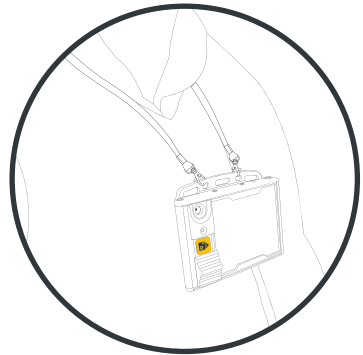
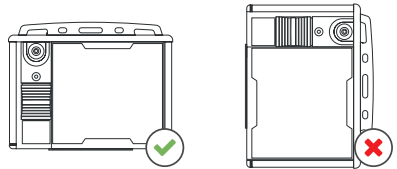

REGULATORY INFORMATION - FCC COMPLIANCE INFORMATION STATEMENT

The products:

Product Name	Model
Edesix VideoBadge	VB-200

have been tested and found to comply with the limits for Class B digital devices, pursuant to part 15 of the FCC Rules. These limits are designed to provide reasonable protection against harmful interference in a residential installation. This equipment generates and can radiate radio frequency energy and, if not installed and used in accordance with the instructions, may cause harmful interference to radio communications. However there is no guarantee that interference will not occur in a particular installation. If harmful interference is suspected, the user should determine its cause by turning the equipment off and on. The user is encouraged to try to correct the interference by one or more of the following measures:

- Reorient or relocate the receiving antenna.
- Increase the separation between the equipment and the receiver.
- Connect the equipment into an outlet on a circuit different from that to which the receiver is connected.
- Consult the supplier or an experienced radio/TV technician for help.

This device complies with the limits specified in part 15 of the FCC Rules. Operation is subject to the following two conditions: (1) This device may not cause harmful interference, and (2) this device must accept any interference received, including interference that may cause undesired operation.

Industry Canada Compliance Information Statement

Canada: CAN ICES-3 (B)/NMB-3(B)

This Class B digital apparatus complies with Canadian ICES-003.

Cet appareil numérique de la classe B est conforme à la norme NMB-003 du Canada.



+44 131 510 0232



sales@edesix.com



www.edesix.com

Reg: SC235672 | VAT: GB 803 904 251